

6 5 4 3 2

**NOTES**

1. MATERIALS:  
 HOUSING: POLYESTER UL 94V-0, COLOR: WHITE.  
 STANDARD CONTACT: PHOSPHOR BRONZE.  
 HIGH CURRENT CONTACT: BRASS.
2. FINISH:  
 STANDARD CONTACT: TIN-LEAD(Sn-Pb);  
 THICKNESS=20 MICROINCH TO 80 MICROINCH.  
 HIGH CURRENT CONTACT: SILVER; THICKNESS=200 MICROINCH,  
 OVER NICKEL; THICKNESS=40 MICROINCH.
3. PRODUCT SPECIFICATION: NONE.
4. DIMENSIONS ARE FOR REFERENCE ONLY UNLESS INDICATED OTHERWISE.
5. HEADER ASSEMBLY MATES WITH: PLUG HOUSINGS .084/(2.13) DIS SERIES:(42021-\*\*).
6. CONTACTS ARE ON .250/(6.35) GRID CENTERLINE SPACING.

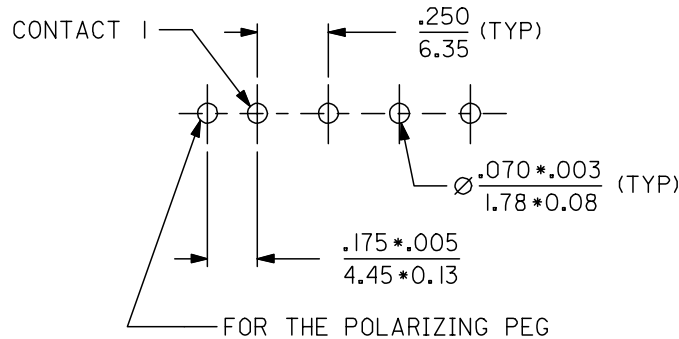
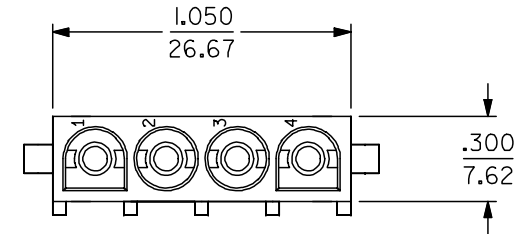

PCB LAYOUT: COMPONENT SIDE  
 RECOMMENDED PCB THICKNESS:  $\frac{0.062}{1.57}$

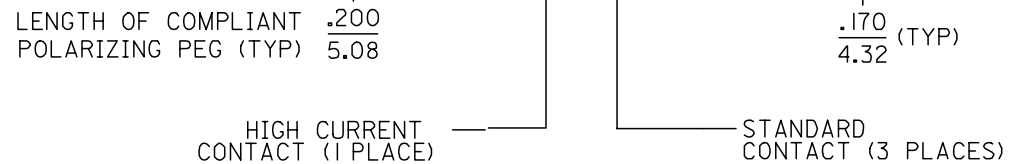

DD-MMM-YYYY  
 HH:MM  
**WORKAREA PLOT**  
 GRP###\$USER\$NAME\$

REV	DESCRIPTION	QUALITY SYMBOLS
MAJOR	0	▲
CRITICAL	0	▽

GENERAL TOLERANCES: (UNLESS SPECIFIED)	
mm	INCH
4 PLACES	±0.10
13 PLACES	±0.10
2 PLACES	±0.25
1 PLACE	±0.36
ANGULAR: ± 1/2°	

SCALE: 25:1	DESIGN UNITS: <input type="checkbox"/> mm <input checked="" type="checkbox"/> INCH	THIRD ANGLE PROJECTION: <input type="checkbox"/> mm <input checked="" type="checkbox"/> INCH	SHT	REV
DRAWN BY & DATE: G.LOWE 22/10/99		TITLE: HEADER ASSEMBLY .084 (2.13) SERIES		
CHECKED BY & DATE: G.LOWE 22/10/99		COMPLIANT POLARIZING PEG		
APPROVED BY & DATE: G.LOWE 22/10/99		MOLEX INCORPORATED		
CAD FILENAME: S-3653701.S01	MATERIAL NO.: 36537-0001	DRAWING No.: SD-36537-001	SHEET No. 1 OF 1	
DRAFT WHERE APPLICABLE MUST REMAIN WITHIN DIMENSIONS				
THIS DRAWING CONTAINS INFORMATION THAT IS PROPRIETARY TO MOLEX INCORPORATED AND SHOULD NOT BE USED WITHOUT WRITTEN PERMISSION.				

5

4

3

2

1

SIZE A