

NOTES:

1.0 SPECIFICATIONS:

1.1 FREQ. RANGE: DC to 18.0 GHz

1.2 ATTENUATION ACCURACY:

0dB	+0.3/-0dB
0.5 - 6dB	±0.3dB
7 - 20dB	±0.5dB
21 - 30dB	±1.0dB

1.3 MAXIMUM VSWR:

	0.5dB	ALL OTHER dB VALUES
DC to 4.0 GHz:	1.12:1	1.12:1
4.0 to 8.0 GHz:	1.18:1	1.15:1
8.0 to 18.0 GHz:	1.25:1	1.20:1

1.4 MAXIMUM INPUT POWER: 2 WATTS AVG AT +25°C DERATED LINEARLY TO 0.5 WATTS AT +125°C

1.5 OPERATING TEMP. RANGE: -65°C to +125°C

 EPOXY UNIT PER EPX-08000-44-01

3.0 MARKING

3.1 MARK UNIT AS SHOWN:

(REF.: INK-03828-27-XX)

4.0 DIMENSIONS IN PARENTHESIS ARE IN MILLIMETERS.

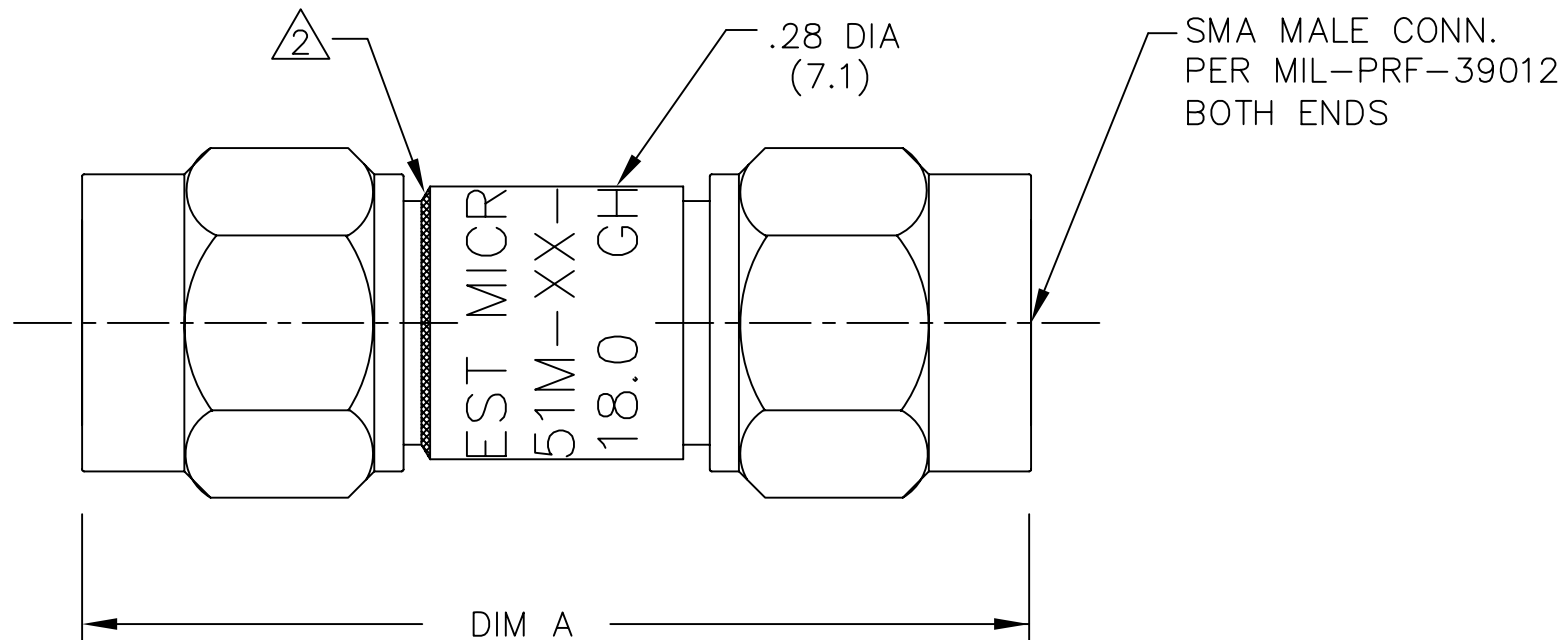

ATTENUATION VALUE	DIM A
1 thru 12dB	.98(24.9)
13 thru 30dB	1.12(28.4)

DWG NO. WAS: 02337-01-00

MODEL NUMBER
ATT-451M-XX-SMA-02
REV.
C1

REV.	DESCRIPTION	DATE
-	RELEASED	2/23/79
A	ECR 5410	6/25/87
B	ECR 6545	6/29/89
C	ECN 13253, REDRAW CAD	3/3/94
c1	ADDED TITLEBLOCK	4/5/05

UNLESS OTHERWISE NOTED DIMENSIONS ARE IN INCHES AND TOLERANCES ARE: 3 PLACE DECIMALS ±.005 2 PLACE DECIMALS ±.02 FRACTIONS ±1/64 PARALLELITY: T.I.R. _____ FLATNESS: T.I.R. _____ CONCENTRICITY: T.I.R. _____ ANGLES AND PERPENDICULARITY: ±1'	FSCM NO. 34078	MIDWEST MICROWAVE	
	NOTICE: The information contained in this drawing is proprietary and must not be used without the permission of Midwest Microwave	TITLE ATTENUATOR	
DRAWN/DATE M.HOLLMAN 3/3/94	ENG./DATE G.KOZAK 3/8/94	DRAWING NUMBER ATT-451M-XX-SMA-02	
CHECKED/DATE A.BEATTY 3/4/94	APPROVED/DATE	SCALE: 5=1	SHEET 1 of 1