

## Saturating Chokes

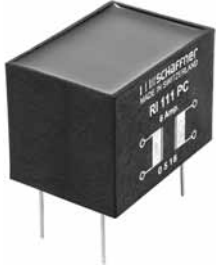

- Rated currents from 1.5 to 25A
- Up to 500VAC operating voltage
- DC to 1kHz frequency
- Single or dual-choke configurations



### Technical specifications

Maximum continuous operating voltage:	500VAC @ 40°C
Operating frequency:	dc to 1kHz
Rated currents:	1.5 to 25A @ 40°C max.
High potential test voltage	
winding-to-winding @ 25°C:	2500VAC, 60 sec, guaranteed
and/or winding-to-inserts:	2500V, 50Hz, 2 sec, factory test
Surge current @ 10msec:	20 X I <sub>nominal</sub> @ 25°C
Temperature range (operation and storage):	-25°C to +110°C (25/110/21)
Flammability corresponding to:	UL 94V-0
MTBF @ 40°C/230V (Mil-HB-217F):	> 5,000,000 hours

### Typical electrical schematic



RI saturating type chokes change impedance at the moment of switching, and can be used to attenuate differential-mode noise or symmetrical interference as generated in fast switching high current applications. These chokes are typically used in conjunction with suppression capacitors. For optimum attenuation chokes must be connected as close as possible to the semiconductor switching device.



### Features and benefits

- Excellent thermal behavior.
- Through hole or wire connections.
- Single or dual-choke configurations.
- Up to 25A single configuration.
- Custom-specific versions are available on request.

### Typical applications

- Suppressing high interference levels generated by fast switching circuits
- DC voltage smoothing
- EMC/EMI filters
- Phase angle control circuits
- Power supplies
- Chargers

**Choke selection table**

Choke	Nominal current @ 40°C	Resistance R	Choke configuration	Input/Output connections	Weight [g]
	[A]	[mΩ/path]	[Qty]	 	
RI 111 PC	6	42	2	02	170
RI 401 PC	1.5	620	1	02	15
RI 403 PC	3	105	1	02	30
RI 406 PC	6	53	1	02	55
RI 410 PC	10	28	1	02	95
RI 415	15	8	1	07	205
RI 425	25	4	1	07	325

Test conditions:

Resistance tolerance: max. ±15% @ 25°C; < 200mΩ, 100mA; > 200mΩ ≤ 2Ω, 10mA

Electrical characteristics @ 25°C: ±2°C

**Typical saturation characteristics**

Inductance (typical value in %) vs. nominal current in %

RI series

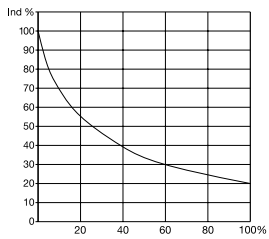

**Mechanical data**

RI 111

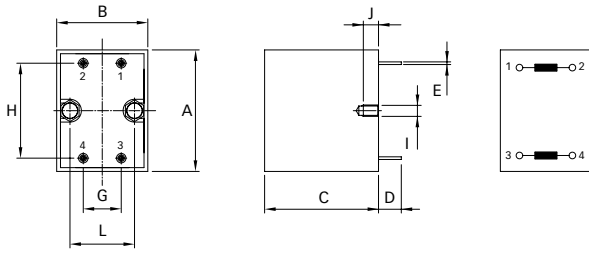

RI 401, RI 403, RI 406

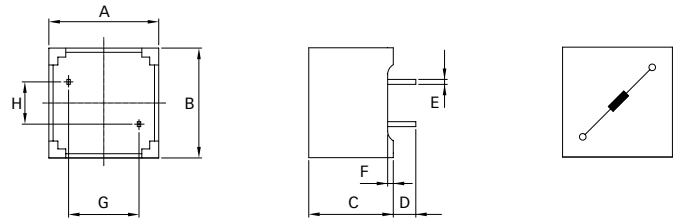

RI 410

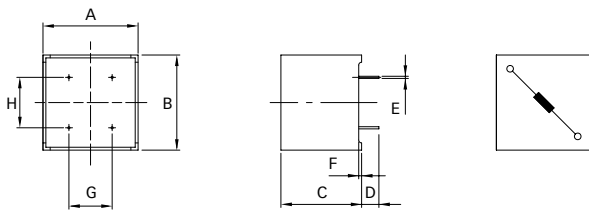

RI 415, RI 425

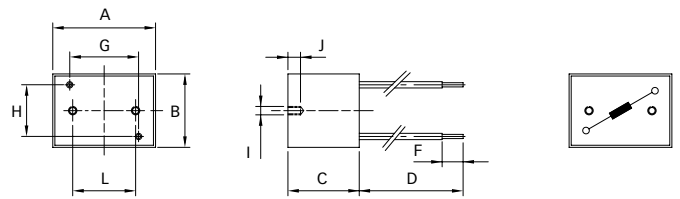

**Dimensions**

	RI 111	RI 401	RI 403	RI 406	RI 410	RI 415	RI 425	Tolerances
<b>A</b>	49	19.5	23.3	28.5	33	35	48	
<b>B</b>	35	19.5	23.3	28.5	33	49	48	
<b>C</b>	34	15	18	21.5	28	34	43	±0.3
<b>D</b>	15	4	6	4.5	6	200	200	
<b>E</b>	Ø1.15	0.6 x 0.88	Ø0.9	0.6 x 0.88	0.75 x 1.1			±0.1
<b>F</b>		1			1	10	10	
<b>G</b>	20	12.5	15	20	17.5	22	39	
<b>H</b>	40	7.5	10	10	15	36	35	
<b>I</b>	M4					M4	M4	
<b>J</b>	6					6	6	+0/-0.5
<b>L</b>	21					30	30	±0.25

All dimensions in mm; 1 inch = 25.4mm  
 Tolerances according: ISO 2768-m / EN 22768-m

**Headquarters and  
global innovation and  
development center**

**Schaffner Group**  
Nordstrasse 11  
4542 Luterbach  
Switzerland  
T +41 32 681 66 26  
F +41 32 681 66 30  
info@schaffner.ch  
[www.schaffner.com](http://www.schaffner.com)

**Sales and application centers**

**China**  
**Schaffner EMC Ltd. Shanghai**  
Building 11, Lane 1365  
East Kangqiao Road  
Shanghai 201319  
T +86 21 6813 9855  
F +86 21 6813 9811  
cschina@schaffner.com  
[www.schaffner.com](http://www.schaffner.com)

**Germany**  
**Schaffner Deutschland GmbH**  
Schoemperlenstrasse 12B  
76185 Karlsruhe  
T +49 721 56910  
F +49 721 569110  
germanysales@schaffner.com

**Finland**  
**Schaffner Oy**  
Tynninkuja 7  
08700 Lohja  
T +358 19 35 72 71  
F +358 19 32 66 10  
finlandsales@schaffner.com

**France**  
**Schaffner EMC S.A.S.**  
112, Quai de Bezons  
95103 Argenteuil  
T +33 1 34 34 30 60  
F +33 1 39 47 02 28  
francesales@schaffner.com

**Italy**  
**Schaffner EMC S.r.l.**  
Via Galileo Galilei, 47  
20092 Cinisello Balsamo (MI)  
T +39 02 66 04 30 45/47  
F +39 02 61 23 943  
italysales@schaffner.com

**Japan**  
**Schaffner EMC K.K.**  
Mitsui-Seimei Sangenjaya Bldg. 7F  
1-32-12, Kamiyama, Setagaya-ku  
Tokyo 154-0011  
T +81 3 5712 3650  
F +81 3 5712 3651  
japansales@schaffner.com  
[www.schaffner.jp](http://www.schaffner.jp)

**Sweden**  
**Schaffner EMC AB**  
Turebergstorg 1, 6  
19147 Sollentuna  
T +46 8 5792 1121/22  
F +46 8 92 96 90  
swedensales@schaffner.com

**Switzerland**  
**Schaffner EMV AG**  
Nordstrasse 11  
4542 Luterbach  
T +41 32 681 66 26  
F +41 32 681 66 41  
sales@schaffner.ch

**Singapore**  
**Schaffner EMC Pte Ltd.**  
Blk 3015A Ubi Road 1  
05-09 Kampong Ubi Industrial  
Estate  
T +65 6377 3283  
F +65 6377 3281  
singaporesales@schaffner.com

**Spain**  
**Schaffner EMC España**  
Calle Caléndula 93,  
Miniparc III, Edificio E  
El Soto de la Moraleja,  
Alcobendas  
28109 Madrid  
T +34 618 176 133  
spainsales@schaffner.com

**Taiwan**  
**Schaffner EMV Ltd.**  
6th Floor, No 413  
Rui Guang Road  
Neihu District  
Taipei City 114  
T +886 2 87525050  
F +886 2 87518086  
taiwansales@schaffner.com

**Thailand**  
**Schaffner EMC Co. Ltd.**  
Northern Region Industrial Estate  
67 Moo 4 Tambon Ban Klang  
Amphur Muang P.O. Box 14  
Lamphun 51000  
T +66 53 58 11 04  
F +66 53 58 10 19  
thailandsales@schaffner.com

**UK**  
**Schaffner Ltd.**  
5 Ashville Way  
Molly Millars Lane  
Wokingham  
Berkshire RG41 2PL  
T +44 118 9770070  
F +44 118 9792969  
uksales@schaffner.com  
[www.schaffner.uk.com](http://www.schaffner.uk.com)

**USA**  
**Schaffner EMC Inc.**  
52 Mayfield Avenue  
Edison, New Jersey 08837  
T +1 732 225 9533  
F +1 732 225 4789  
usasales@schaffner.com  
[www.schaffner.com/us](http://www.schaffner.com/us)

To find your local partner within  
Schaffner's global network, please go to

[www.schaffner.com](http://www.schaffner.com)

May 2011

© 2011 Schaffner EMC.  
Specifications subject to change without  
notice. All trademarks recognized.

Schaffner is an ISO-registered company.  
Its products are designed and manufac-  
tured under the strict quality and environ-  
mental requirements of the ISO 9001 and  
ISO 14001 standards.

This document has been carefully  
checked. However, Schaffner does not  
assume any liability for errors or inac-  
curacies.